

For Lease

717.293.4477



## KEYSTONE COURT LEOLA, PA 17540

Ruth M. Devenney, CCIM, SIOR  
717.293.4552 – direct line  
rdevenney@high.net

Michael Bowser  
717-293-4553 – direct line  
mbowser@high.net



**▶ Retail/Office Building**



*Keystone Court  
Leola, PA 17540*

**Total Square Feet:**  
556 to 1,244 square feet

**Lease Rate:**  
See monthly rates on the next page

**Description:**  
Small office or retail spaces offered at very affordable lease rates that include all operating expenses and utility costs. Call today for details.

Ruth M. Devenney, CCIM, SIOR  
717.293.4552 – direct line  
rdevenney@high.net

Michael Bowser  
717.293.4553 – direct line  
mbowser@high.net

**PROPERTY INFORMATION**

Retail/Office Space	See next page for square footages and rent rate
Year Constructed	1900 & 1970 - renovated in 2017
Type Construction	Wood frame
Ceiling Height	8 - 9 feet
Electric	Included in rent
Lighting	Fluorescent
Water & Sewer	Public
Municipality	Upper Leacock Township
Zoning	Mixed Use

Information furnished regarding property for sale or rent is from sources deemed reliable, but is not guaranteed. No warranty or representation is made as to accuracy thereof and is submitted subject to errors, omissions, change of price, or other conditions, prior sale or lease or withdrawal without notice. No liability of any kind is to be imposed on the broker herein.

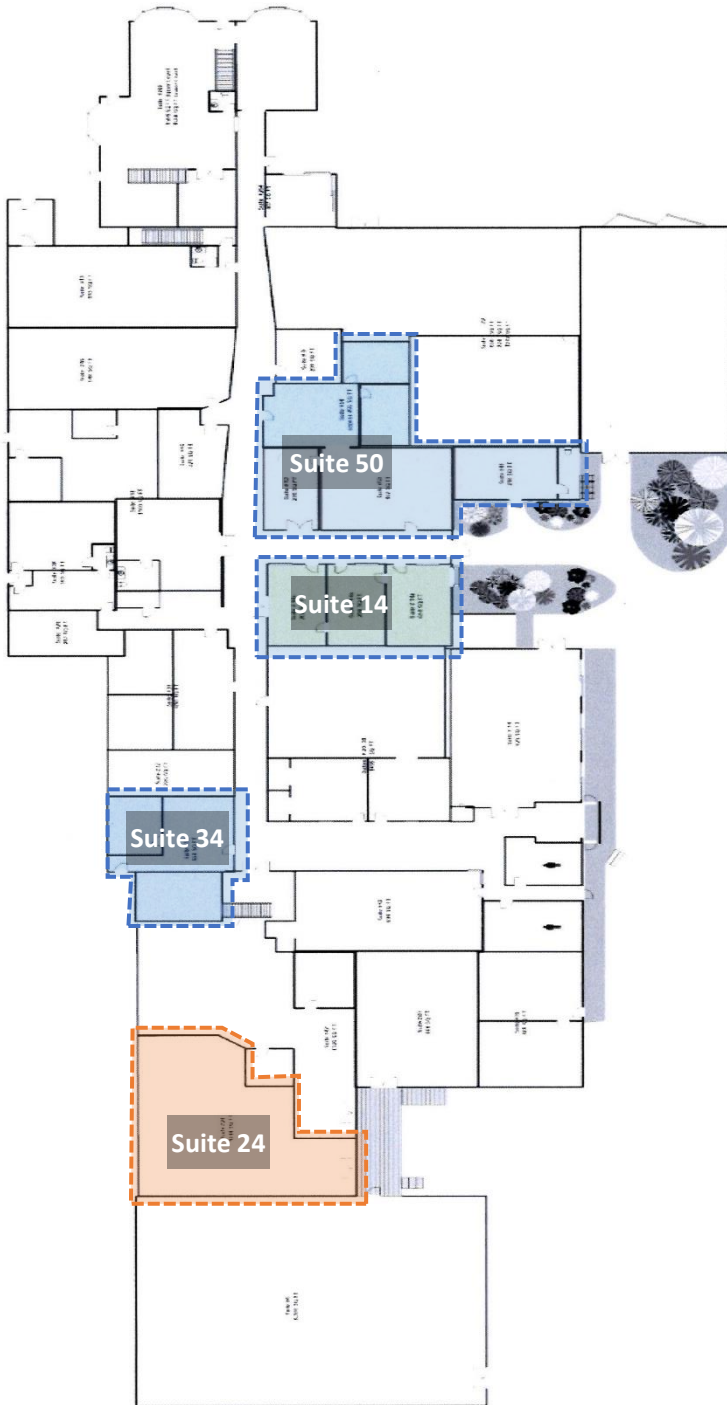

## Available Suites:

The rental rates are inclusive of all operating expenses and utilities (electric, etc.).

**Suite 50 – Office/Retail**  
\$1,350 per month  
1,150 square feet

**Suite 14 – Office/Retail**  
\$960 per month  
821 square feet

**Suite 34 – Office**  
\$695 per month  
556 square feet

**Suite 24 - Office/Storage**  
\$1,015 per month  
1,244 square feet  
W/ loading dock  
(for sublease)



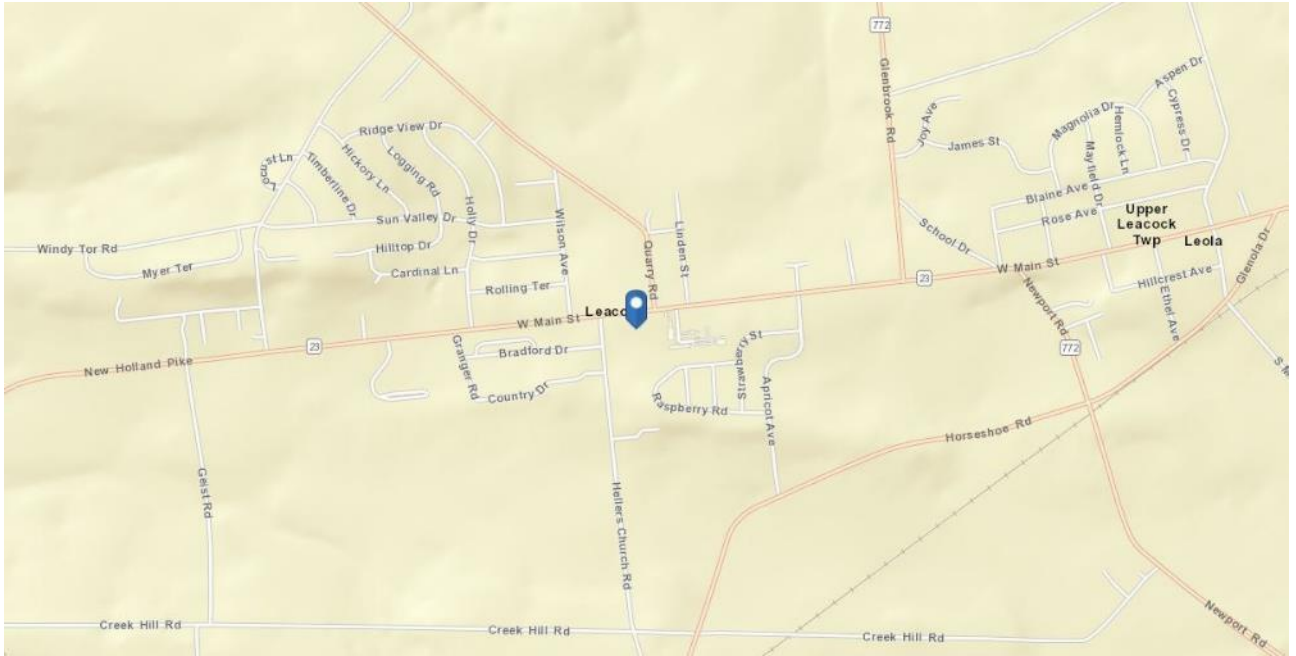



*Every company dreams its dreams and sets its standards  
These are ours . . .*

*We are committed to two great tasks:*

**1. BUILDING TRUSTWORTHY RELATIONSHIPS.**

- Valuing our customers and meeting their needs.
- Respecting the dignity of all co-workers and their families.
- Energizing our teamwork with participative management.
- Recognizing and rewarding the accomplishments of our co-workers.
- Strengthening our partnership with suppliers.
- Contributing to a world of beauty and prosperity and peace.

**2. BEING INNOVATIVE LEADERS.**

- Creating an environment for innovation since 1931.
- "Right the first time" – High quality products and services.
- Investing profits to secure our future.

**WE GIVE GOOD MEASURE.**



1853 William Penn Way  
Lancaster, PA 17601  
717.291.2284  
717.293.4488 Fax  
1.800.638.4414

5000 Ritter Road, Suite 201  
Mechanicsburg, PA 17055  
717.697.2422  
717.697.0870 Fax  
1.800.213.0094

525 Highlands Boulevard, Suite 107  
Coatesville, PA 19320  
610.380.8437  
610.380.0583 Fax

*Information furnished regarding property for sale or rent is from sources deemed reliable, but is not guaranteed. No warranty or representation is made as to accuracy thereof and is submitted subject to errors, omissions, change of price, or other conditions, prior sale or lease or withdrawal without notice. No liability of any kind is to be imposed on the broker herein.*