

# For Lease



## 454 NEW HOLLAND AVE LANCASTER, PA 17601

Ruth M. Devenney, CCIM, SIOR  
717.293.4552 – direct line  
rdevenney@high.net

Michael Bowser  
717-293-4553 – direct line  
mbowser@high.net

For Lease

454 New Holland Ave  
Lancaster, PA 17601

▶ Professional Office Space



454 New Holland Ave  
Lancaster, PA 17601

**Available Square Feet**

3<sup>rd</sup> Floor: 4,850 SF to 9,950 SF  
(with Elevator)

1<sup>st</sup> Floor: 305 SF to 2,326 SF

**Lease Rate**

\$14.50 NNN

**Description**

The third-floor suites have a full office build-out and have elevator access. The first-floor suites are presently in raw condition and have a generous tenant improvement allowance so you can design a move-in ready suite.

**BUILDING INFORMATION**

<b>Total Square Feet</b>	<u>3<sup>rd</sup> Floor:</u> Up to 9,950SF	<b>Parking</b>	178 spaces on site
	<u>1<sup>st</sup> Floor:</u> Up to 2,326 SF	<b>Water</b>	Public
<b>Lease Rate</b>	\$14.50 NNN	<b>Sewer</b>	Public
<b>Annual CAM</b>	\$4.33 PSF	<b>Zoning</b>	Mixed Use
<b>HVAC</b>	Central	<b>Municipality</b>	City of Lancaster

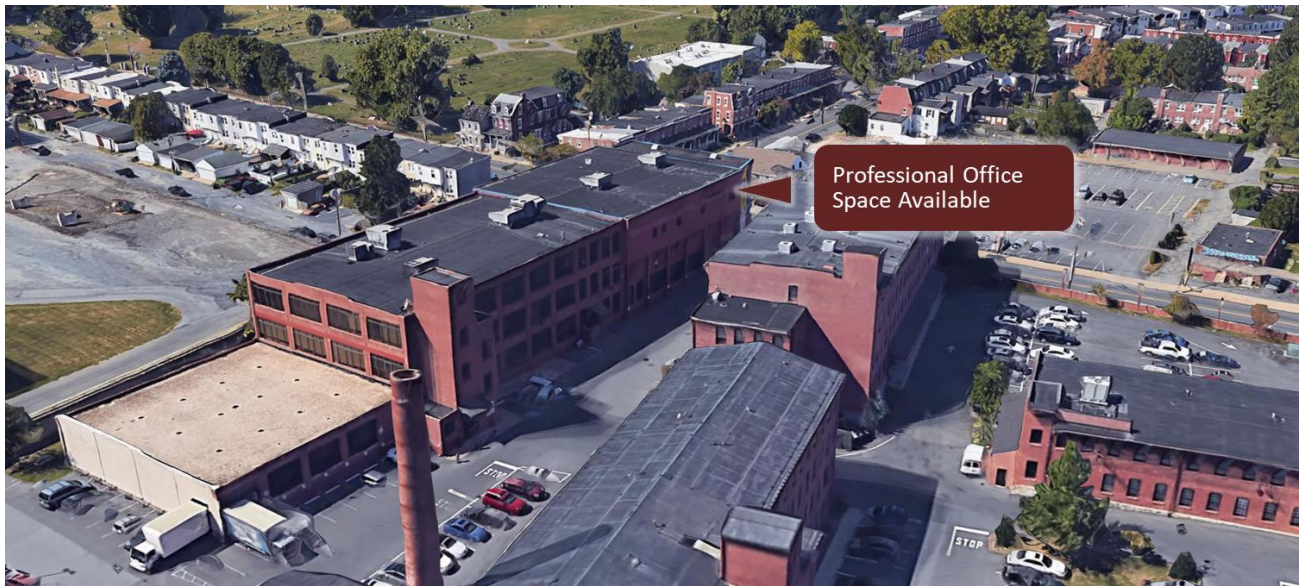

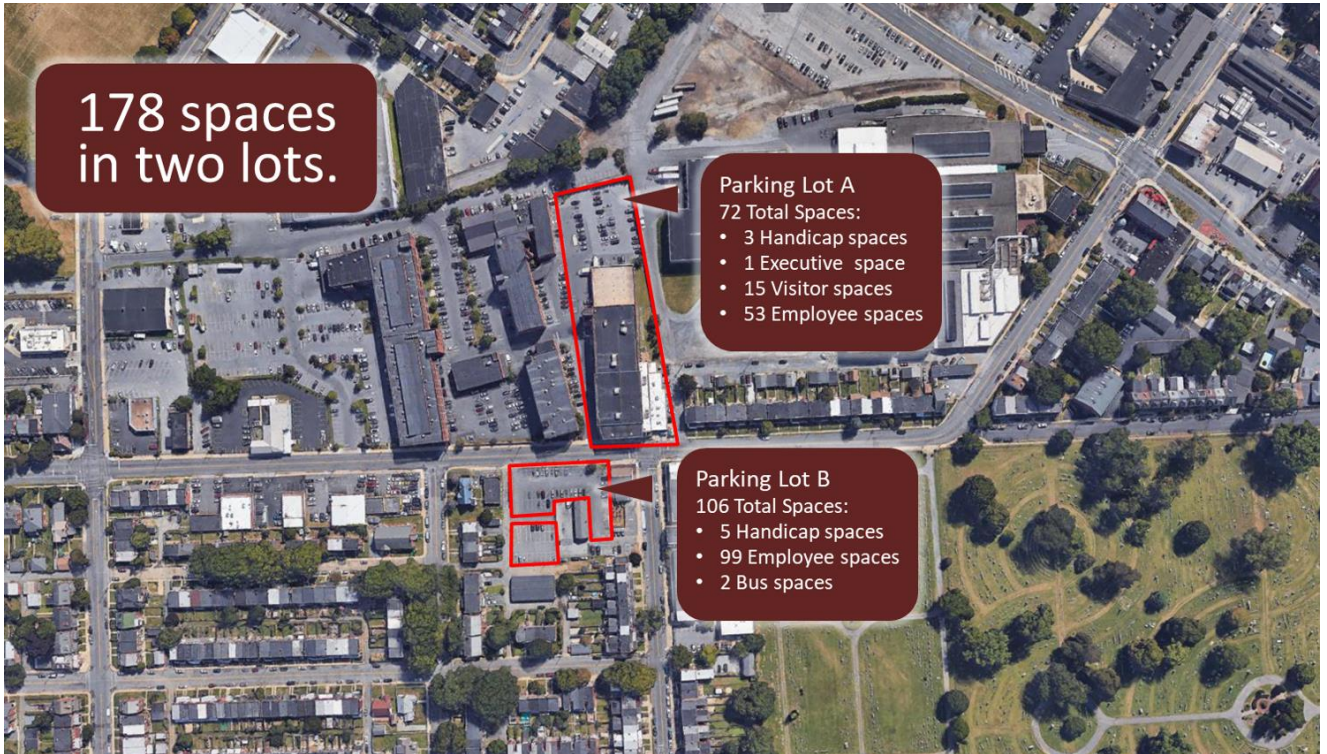

## 1<sup>st</sup> Floor

- 305 SF
- 900 SF
- 2,326 SF

### Combinations:

- 1,205 SF

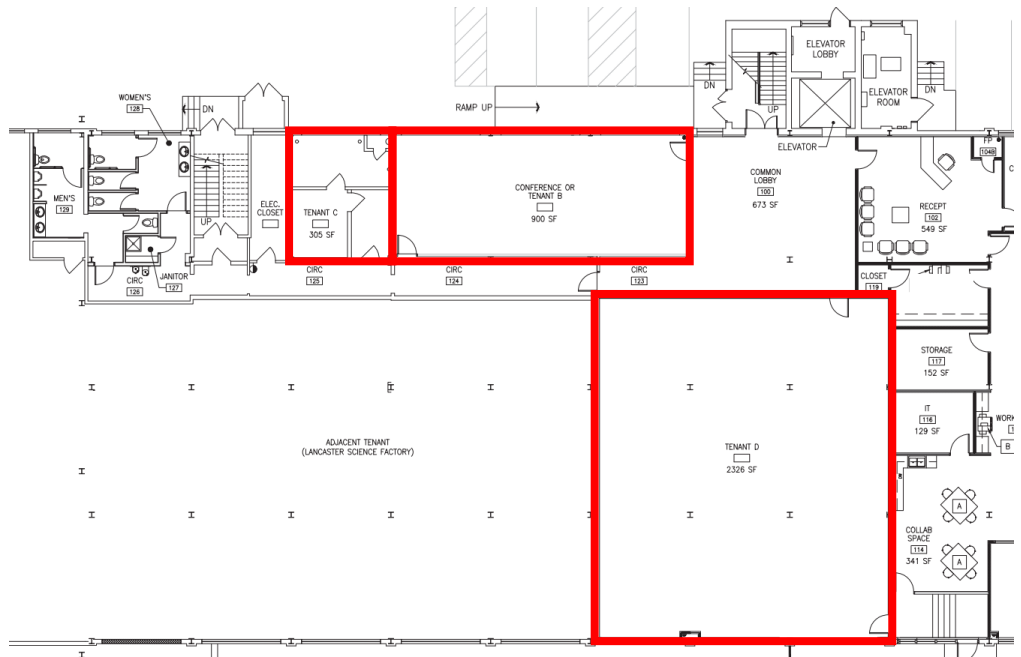

## 3<sup>rd</sup> Floor

- 4,850 SF
- 5,100 SF

### Combinations:

- 9,950 SF

***The floor plan for the third floor will be available soon. Please contact the agent for additional information.***



## 2020 ESRI Data

**Population**

1 MILE	– 35,472
3 MILES	– 108,644
5 MILES	– 183,769

**Average HHI**

1 MILE	– \$54,343
3 MILES	– \$70,624
5 MILES	– \$81,313

**Households**

1 MILE	– 13,230
3 MILES	– 41,4735
5 MILES	– 71,329





*Every company dreams its dreams and sets its standards  
These are ours . . .*

*We are committed to two great tasks:*

**1. BUILDING TRUSTWORTHY RELATIONSHIPS.**

- Valuing our customers and meeting their needs.
- Respecting the dignity of all co-workers and their families.
- Energizing our teamwork with participative management.
- Recognizing and rewarding the accomplishments of our co-workers.
- Strengthening our partnership with suppliers.
- Contributing to a world of beauty and prosperity and peace.

**2. BEING INNOVATIVE LEADERS.**

- Creating an environment for innovation since 1931.
- "Right the first time" – High quality products and services.
- Investing profits to secure our future.

**WE GIVE GOOD MEASURE.**



1853 William Penn Way  
Lancaster, PA 17601  
717.291.2284  
717.293.4488 Fax  
1.800.638.4414

5000 Ritter Road, Suite 201  
Mechanicsburg, PA 17055  
717.697.2422  
717.697.0870 Fax  
1.800.213.0094

525 Highlands Boulevard, Suite 107  
Coatesville, PA 19320  
610.380.8437  
610.380.0583 Fax

*Information furnished regarding property for sale or rent is from sources deemed reliable, but is not guaranteed. No warranty or representation is made as to accuracy thereof and is submitted subject to errors, omissions, change of price, or other conditions, prior sale or lease or withdrawal without notice. No liability of any kind is to be imposed on the broker herein.*