

FOR LEASE

29 East King Street



LANCASTER, PA 17602

**FIRST FLOOR RETAIL SPACE IN
WALKABLE DOWNTOWN
LANCASTER**

**ABILITY TO CUSTOMIZE TO
TENANT NEEDS**

RUTH M. DEVENNEY, CCIM, SIOR F. JEFFREY KURTZ, CCIM

717.293.4552

rdevenney@high.net

717.293.4554

jkurtz@high.net

HIGH ASSOCIATES LTD. • 1853 WILLIAM PENN WAY • LANCASTER, PA 17601 • 717.293.4477 • HIGHASSOCIATES.COM
Information furnished regarding property for sale or rent is from sources deemed reliable but is not guaranteed. No warranty or representation is made as to accuracy thereof and is submitted subject to errors, omissions, change of price, or other conditions, prior sale or lease or withdrawal without notice. No liability of any kind is to be imposed on the broker herein.



FOR LEASE

29 East King Street



LEASE INFORMATION

Lease Rate:	\$16.00 SF/yr (NN)
County:	Lancaster
Municipality:	City of Lancaster
CAM:	\$1.31
Available SF:	3,300 SF

PROPERTY OVERVIEW

First floor street front retail space located in a highly desirable location in the heart of downtown Lancaster. Space will be delivered as a warm, bright, vanilla box but can be fit to Tenants customized needs. Additional storage available in lower level as needed.

OFFERING SUMMARY

HVAC:	Central	Lighting:	By Landlord
Water:	Public	Number of Floors:	1
Sewer:	Public		
Zoning:	CBD		

ADDITIONAL COMMENTS

Bright and airy adjacent outdoor seating area makes this space especially appealing.



RUTH M. DEVENNEY, CCIM, SIOR
717.293.4552
rdevenney@high.net



F. JEFFREY KURTZ, CCIM
717.293.4554
jkurtz@high.net

FOR LEASE

29 East King Street

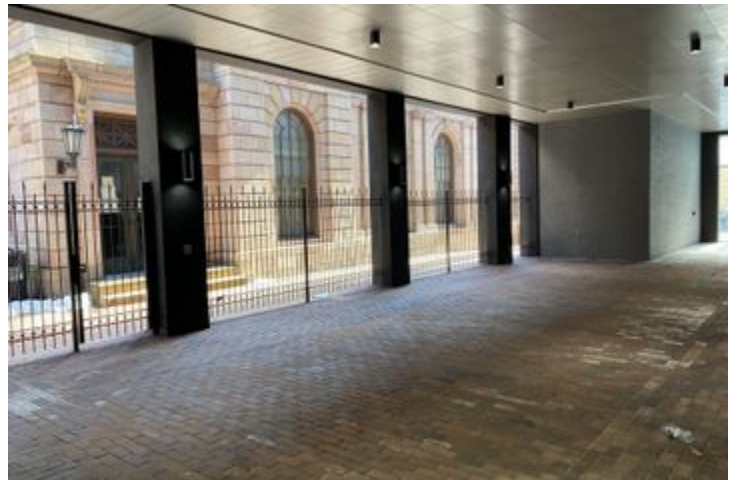

RUTH M. DEVENNEY, CCIM, SIOR
717.293.4552
rdevenney@high.net

F. JEFFREY KURTZ, CCIM
717.293.4554
jkurtz@high.net

FOR LEASE

29 East King Street

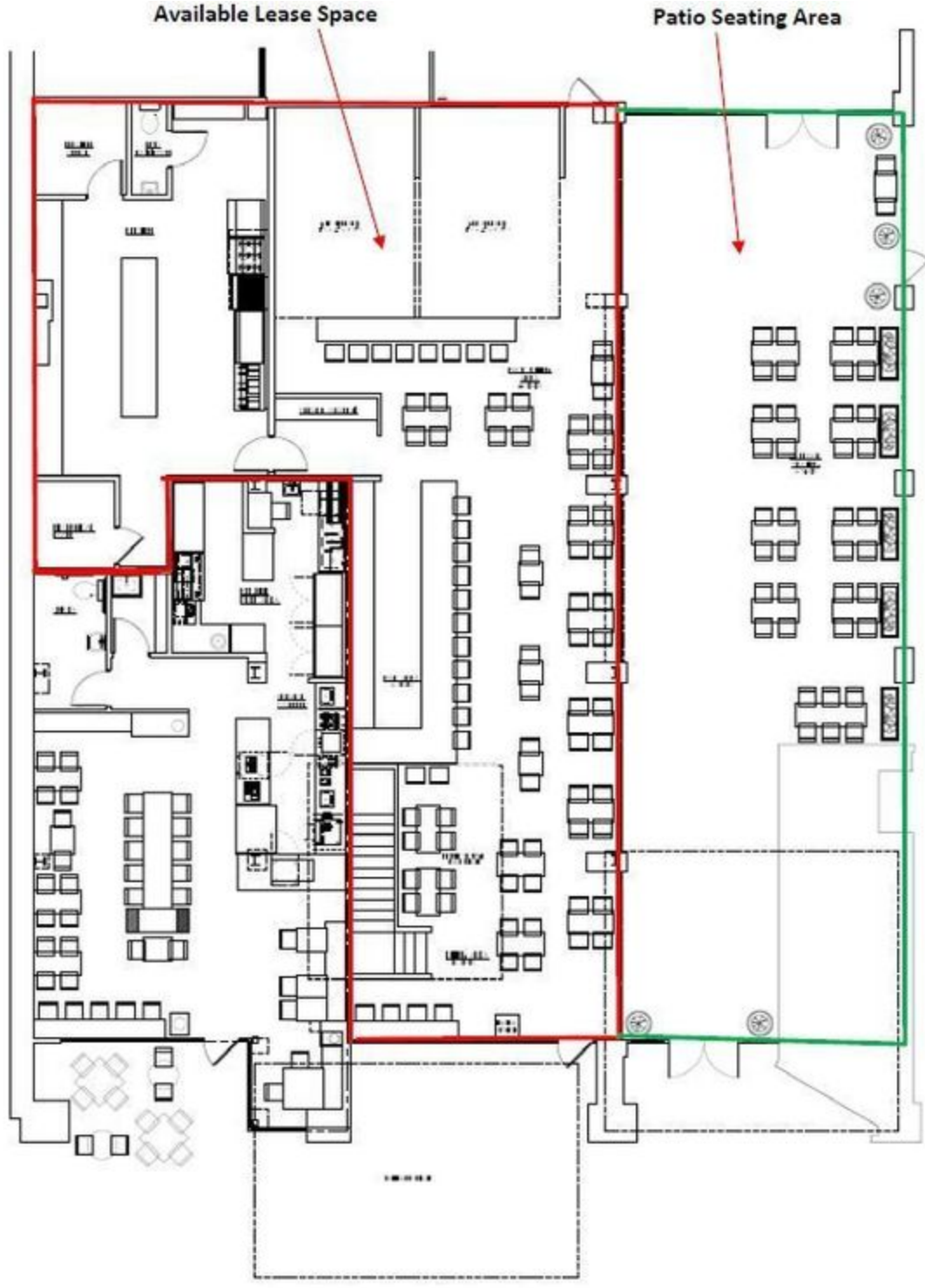

RUTH M. DEVENNEY, CCIM, SIOR
717.293.4552
rdevenney@high.net

F. JEFFREY KURTZ, CCIM
717.293.4554
jkurtz@high.net

FOR LEASE

29 East King Street



RUTH M. DEVENNEY, CCIM, SIOR
717.293.4552
rdevenney@high.net

F. JEFFREY KURTZ, CCIM
717.293.4554
jkurtz@high.net

FOR LEASE

29 East King Street



RUTH M. DEVENNEY, CCIM, SIOR

717.293.4552
rdevenney@high.net

F. JEFFREY KURTZ, CCIM

717.293.4554
jkurtz@high.net

FOR LEASE

29 East King Street

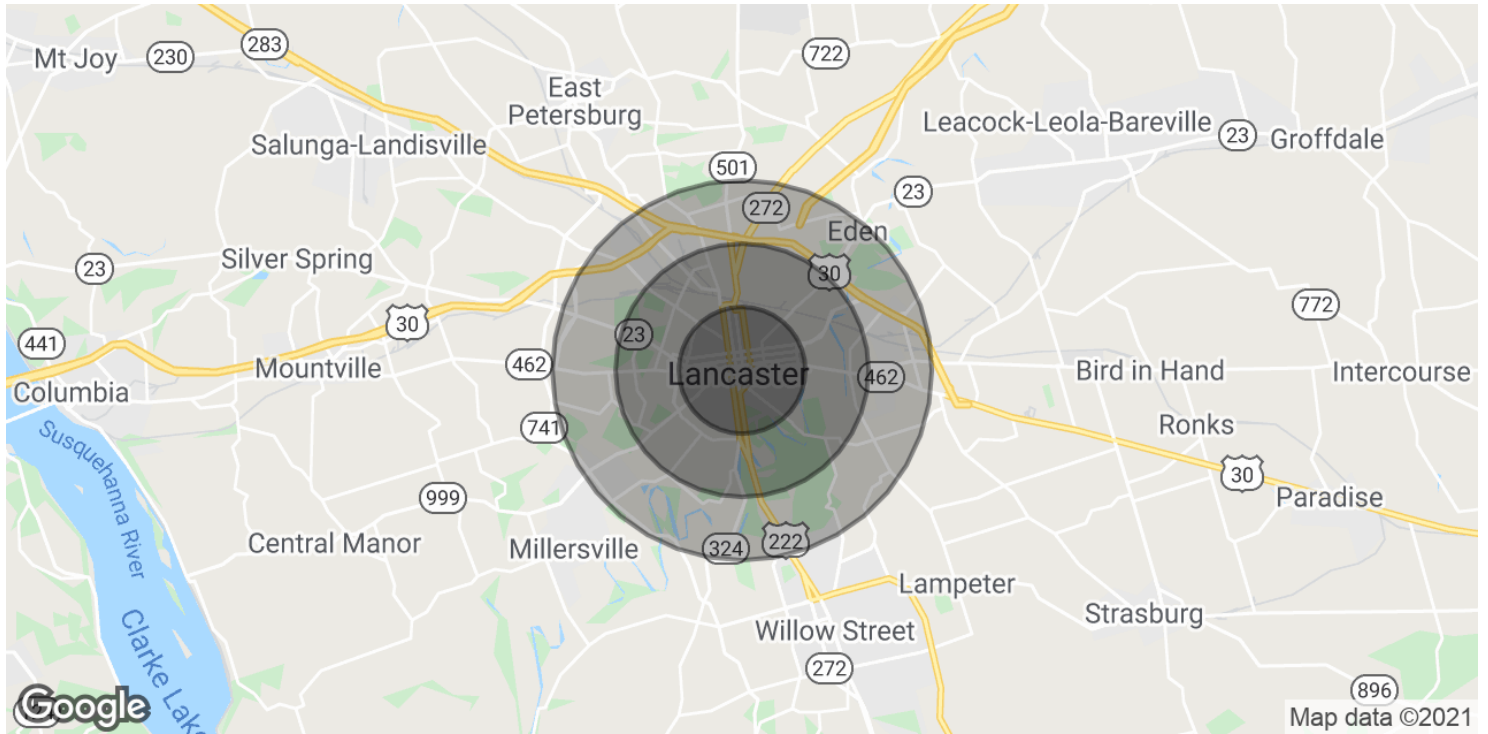

POPULATION	1 MILE	2 MILES	3 MILES
Total Population	43,371	88,660	117,066
Average age	29.7	32.1	34.7
Average age (Male)	28.6	30.5	33.0
Average age (Female)	30.9	33.3	36.0
HOUSEHOLDS & INCOME	1 MILE	2 MILES	3 MILES
Total households	16,439	33,605	45,434
# of persons per HH	2.6	2.6	2.6
Average HH income	\$36,750	\$45,307	\$52,643
Average house value	\$114,369	\$121,361	\$144,760

* Demographic data derived from 2010 US Census

RUTH M. DEVENNEY, CCIM, SIOR

717.293.4552
rdevenney@high.net

F. JEFFREY KURTZ, CCIM

717.293.4554
jkurtz@high.net

FOR LEASE

29 East King Street



An Affiliate of High Real Estate Group LLC

*Every Company dreams its dreams and sets its standards
These are ours . . .*

We are committed to two great tasks:

1. BUILDING TRUSTWORTHY RELATIONSHIPS.

- Valuing our customers and meeting their needs.
- Respecting the dignity of all co-workers and their families.
- Energizing our teamwork with participative management.
- Recognizing and rewarding the accomplishments of our co-workers.
- Strengthening our partnership with suppliers.
- Contributing to a world of beauty and prosperity and peace.

2. BEING INNOVATIVE LEADERS.

- Creating an environment for innovation since 1931.
- "Right the first time" - High quality products and services.
- Investing profits to secure our future.

WE GIVE GOOD MEASURE.

1853 WILLIAM PENN WAY
Lancaster, PA 17601
717.293.4477

5000 RITTER ROAD SUITE 201
P.O. Box 1367
Mechanicsburg, PA 17055